

Short Report 2009-2012

Community Architects Network - CAN

# Let people be the solution



The role of a professional such as an architect, is to learn what is valuable in the tradition, culture and local experience of people and try to find out ways in which improvement can be made.

Fr. Jorge Anzorena





# CAN's Background

:How we link and work together

The Community Architects Network (CAN) is a regional network of community architects and planners, engineers, young professionals, lecturers and academic institutes in Asian countries. Established in 2010, the network has been supporting community-driven projects regarding people housing, city-wide upgrading, and recovery from disaster of Asian Coalition for Community Action programme (ACCA). The role of community architect is to build the capacity of people, through participatory design and planning process to make people be their own solution.

Since 2010 when networking started, there are now 27 groups of young professionals in 17 Asian countries that are involved in the network and are working on participatory design and planning, city-wide mapping and survey, seeking design solutions to improve the quality of life and health of communities, as well as training community builders.

Our objectives are as follows:

1. To build capacities of local professionals like community builders, young architects, engineers and planners by organizing hands-on workshops on actual projects.
2. To link with local universities, and colleges with faculties of Architecture, Engineering, and Urban Planning by sharing our network experience and bringing all active agents into the field to work with communities on actual projects.
3. To link with local government and work together with them in pilot projects so they can learn, support, and also continue this working in this kind of process in future.
4. To link with local organizations that work with communities in related issues.
5. To share emerging knowledge and experiences by producing handbooks, documentary films, and newsletter.

1. Regional CAN meeting in Penang, Malaysia, August 2011

2. 1st Regional CAN meeting in Chiangmai, Thailand, June 2010

3. Regional Training on Bamboo in Davao, Philippines, January 2011

# Our Role as Professionals

in Community-Driven Process

To create the conditions for change where both physical and social transformation could take place through the design and planning

## Stream of comprehensive site planning and construction processes



## Stream of social and political processes



**:Our Activities**

## **City-Wide & Community Mapping**

Creating a common understanding of existing settlements at both city and community scales, and to see what possibilities there are for planning and improvement

## **Upgrading**

Providing basic infrastructure designs and construction processes that are owned by the people, and where physical upgrading can enhance the community building process

## **Comprehensive Site Planning**

Through participatory design and planning process, the settlement means more than road pattern layouts on vacant land; it is a process wherein a sense of living, people culture and social system start to grow when people start to plan

## **Community Builder Training**

The community builders are the craftsmen or skillful people in the locality. Training of community builders is an enhancing process of their skills so as to enable the spirit of craft to meet with appropriate technologies

## **Academic Engagement**

Introducing the roles of architect and engineer in responding to housing crisis, disaster, heritage conservation and community upgrading through design and planning tools, by co-hosting workshops with academic institutions

## **Knowledge Sharing**

Producing documentary films, handbooks, and holding hands-on workshops and training

## **Communication**

website, facebook, blog, e-mewsletter, regional and informal meetings



# City-Wide Mapping

## COMMUNITY MAPPING IN LAUTOKA, FIJI

It is very important that people understand how mapping can be a useful tool for them. How can they use the information in negotiating for rights to land, housing and infrastructure? If they know their information better than the land owners and authorities, they have a powerful edge! So it is important that the people can always keep this information and spread it among themselves. @ Picture by Hugo Moline

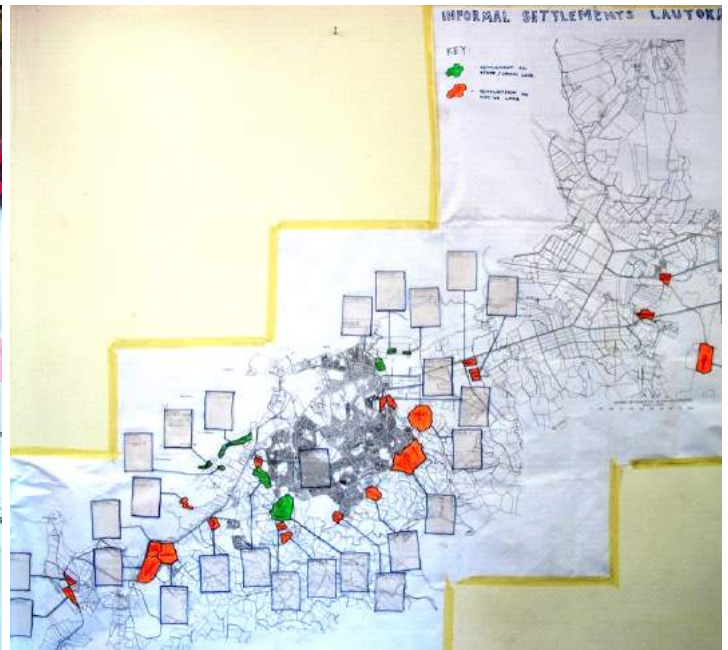

KEY:

-  NATIVE LAND
-  STATE LAND
-  SITE IDENTIFIED FOR NEW SETTLEMENT

### BIG PROJECT NEARBY RELOCATION



### SMALL PROJECT DRAINAGE & ROAD REPAIR



### SMALL PROJECT SEAWALL DRAINAGE & ROAD REPAIR



### SMALL PROJECT FOOTPATH & DRAINAGE



### SMALL PROJECT DRAINAGE



### SMALL PROJECT REDOATABLE HOUSE



### SMALL PROJECT WATERTANKS



### BIG PROJECT AGRO-FOREST RESETTLEMENT



### SMALL PROJECT ROAD REPAIR



### SMALL PROJECT DRAINAGE & ROAD REPAIR

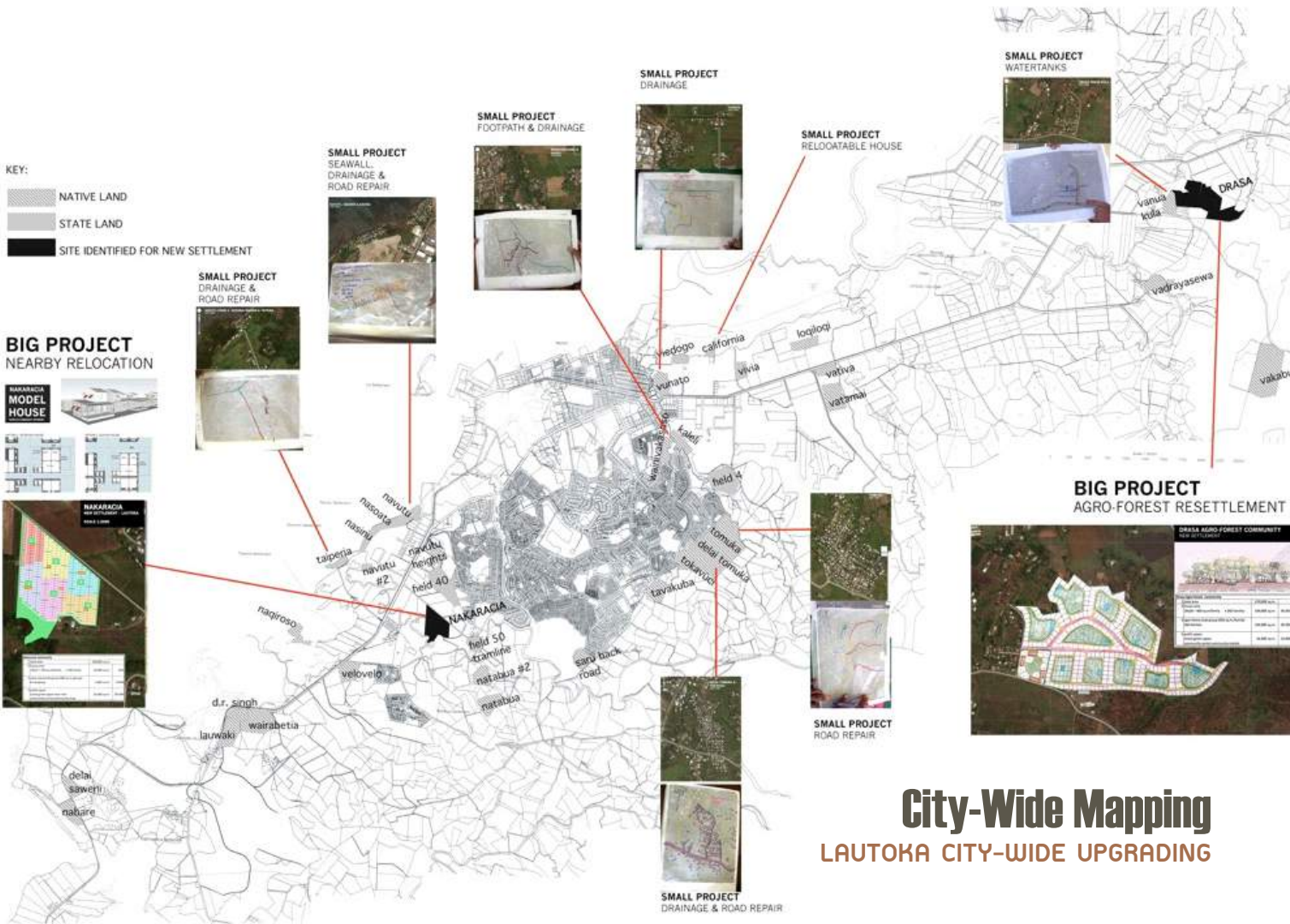

# City-Wide Mapping

## LAUTOKA CITY-WIDE UPGRADING

# City-Wide Mapping

## Using the map to negotiate for land

Some of the community representatives took the large map to the local Lands Department. The people there were very amazed as they had not seen a map which showed all the informal settlements in the whole city picture.

We asked the officials to show us on the maps where any land might be available. They nominated 2 parcels of land. One was quite close to a number of coastal settlements in danger of flooding from a nearby industrial development and climate change. @ Picture by Hugo Moline

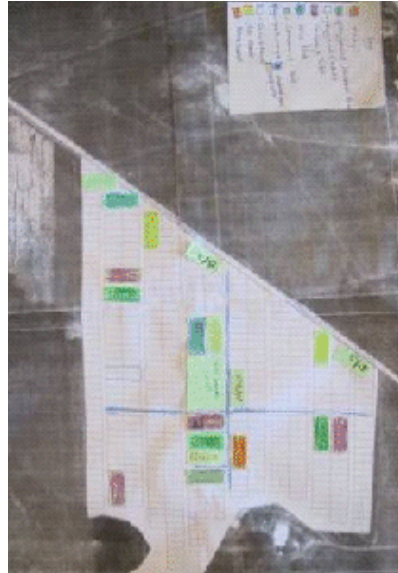







## Upgrading

The success of the bamboo bridge has not only given the people new courage and energy to stay where they are and confirm the wisdom that they used to have, but also it has also given the right place where university can find the right role to contribute in supporting community. @ Picture by Andrea Fitrianto





## Upgrading

Recovery from Merapi volcano eruption

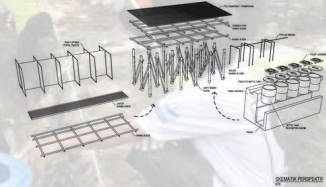

Disasters always bring tragedy, but they also open up an opportunity for change in the affected communities. Disasters offer a chance to turn a negative and desperate situation into a possible longer-term positive outcome. @ Picture by Yuli Kusworo

# Upgrading

Re-blocking at  
Nongdounthungcommunity,  
in Vientiane, Lao PDR

By starting the small upgrading, communities change, the relationships within communities change into the active ones being the doers, the owners of the project. Consequently and collectively people start to think about a longer term plan, after having been encouraged by their small success..@ Picture from Maykham Sintara, and Illustration by Supawut Boonmahathanakorn and Thanawin Wijitporn



# Comprehensive Site Planning

workshop in Gopalganj, Bangladesh



The architect can learn from traditional space usage of people in a settlement, once they listen to the people. Having this understanding, he/she can facilitate how people's aspirations can meet with local wisdom through a design and planning process. @

Picture by Supawut Boonmahathanakorn, and Illustration by Thanawin Witjiporn



# Comprehensive Site Planning

Site planning and low cost housing workshop, Yangon, Myanmar

The architect can help people visualize their houses and their community plan through model-making. With key issues and ideas shown by people's models, the architect can help to transform the ideas into accurate construction drawings in which people can build by themselves.

@ Picture from Chawanad Luansang

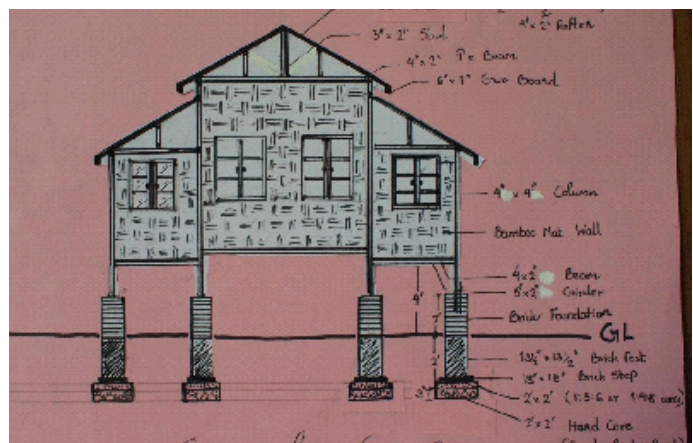

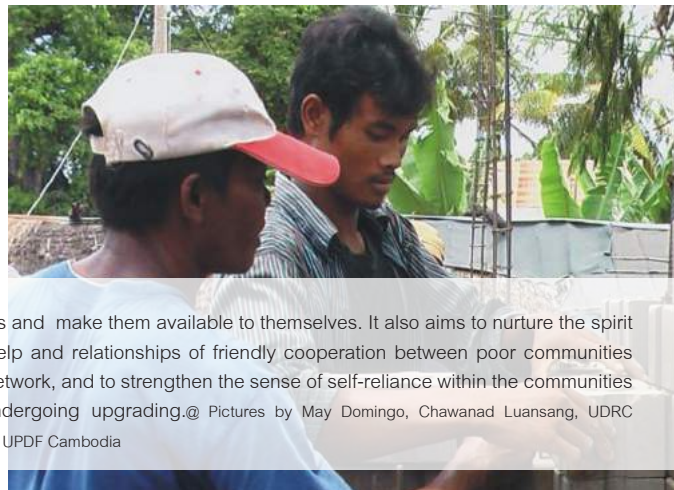

## Community Builder Training

The concept of the community builder training is to strengthen the network of skilled craftspeople within the poor communities, in order to keep the benefits of these skills within the

communities and make them available to themselves. It also aims to nurture the spirit of mutual-help and relationships of friendly cooperation between poor communities within the network, and to strengthen the sense of self-reliance within the communities that are undergoing upgrading. @ Pictures by May Domingo, Chawanad Luansang, UDRC Mongolia, and UPDF Cambodia



## Community Builder Training

We don't like to work with contractors. We know the people have their own artisans; we see them in the paintings, and some of them are still alive. In 1961, traditional crafts were outlawed. For forty years there was a gap in the transmission of knowledge about traditional crafts, but now these artisans are ready to come out and start teaching about their heritage.

@ Picture by Tibet Heritage Funds





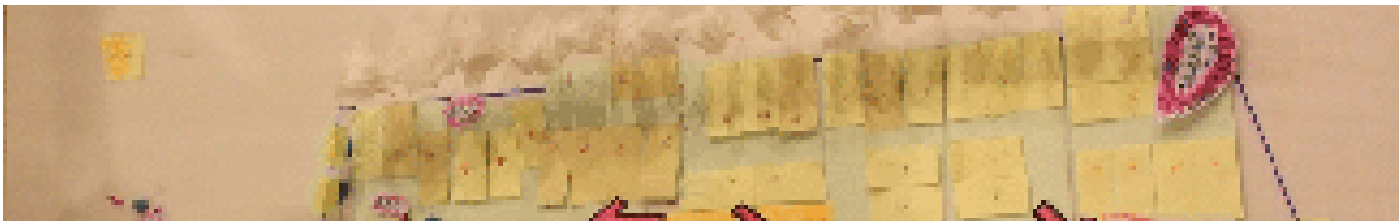

## Academic Engagement

We need a different way of teaching to facilitate this new kind of participatory, community-based planning. A new breed of community architect is needed. There is still a great need for more people to get involved in tackling these enormous problems, and the university can play in this new direction in developing this new breed of community architects. @ Picture by Supawut Boonmahathanakorn and Chawanad Luansang



## National and Regional CAN meeting

We need processes that take advantage of our natural ability to network, to communicate when something is meaningful to us. We need processes that invite us to participate, that honor our creativity and commitment to the organization.

By Margaret J. Wheatly

All documents are downloadable at <http://www.achr.net/achrdownloads.htm>



Documentary Film: Documentation of meeting  
Regional Community Architects Meeting 2010



Documentary Film: Documentation  
of working process  
Design with People

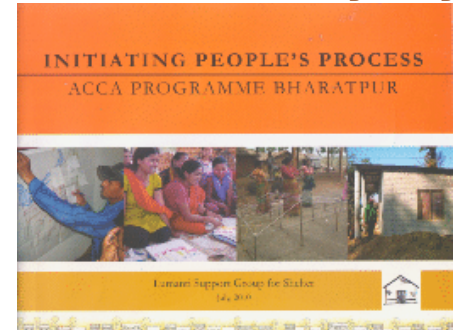

Publication: Report and documentation of working process  
Initiating People's Process  
on ACCA programme Bharatpur

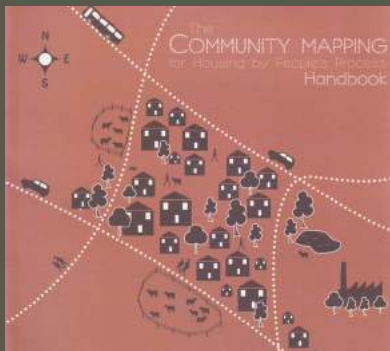

Publication: Handbook  
Community Mapping for Housing by  
People's Process



Publication: Handbook  
Comprehensive Site Planning



Publication: Compilation of case studies  
Design by.with.for People: community  
architects in Asia 2010

**Achievement** : from 2009-2012

## **Community Architect seed funds**

9 countries : Vietnam, Thailand, Lao PDR, Cambodia, Myanmar, Nepal, Indonesia, Malaysia, Fiji

## **Support for community architect workshops, and national workshops, according to need and demand**

12 Countries : India, Vietnam, Thailand, Philippines, Mongolia, Lao PDR, Cambodia, Myanmar, Nepal, Indonesia, Malaysia, Fiji

## **Support, building capacity, training, of community members in technical skills and networking**

7 Countries : Philippines, Mongolia, Cambodia, Myanmar, Indonesia, Fiji, THF

## **Activities linking professionals/students with communities, such as internships, summer schools, workshops on curricula reform**

10 Countries : Vietnam, Thailand, Philippines, Mongolia, Lao PDR, Cambodia, Myanmar, Nepal, Pakistan, Indonesia

2 international academic institutions : University College of London, Global Studio

## **Studies, publications, and handbooks**

1 Action Research : on Bamboo as the low cost material in Cambodia

2 Handbooks : Mapping, Site Planning

2 Publications : Design by.with.for People, Process in Bharatpur

2 Articles : on Environment and Urbanization journal

## **Regional meetings**

4 Times in 3 Countries : Thailand, Indonesia, Malaysia

## **CAN website**

on going process

17 countries, 27 groups : **Our Growth**

## 2012

Looking for sub-regional mechanism  
Ground yourself in community, and work at city scale  
Link with global academic institutions

## 2011

Emergence of new groups  
Network working together in many cities (exchange and learning process)  
Linking with universities  
Started to produce handbooks

## 2010

1st Regional Community Architects Meeting  
CAN was formed as a network

## 2009

ACCA programme started  
June 2009, 2 coordinators started work at ACHR office  
Presence of scattered friends and groups working in different countries

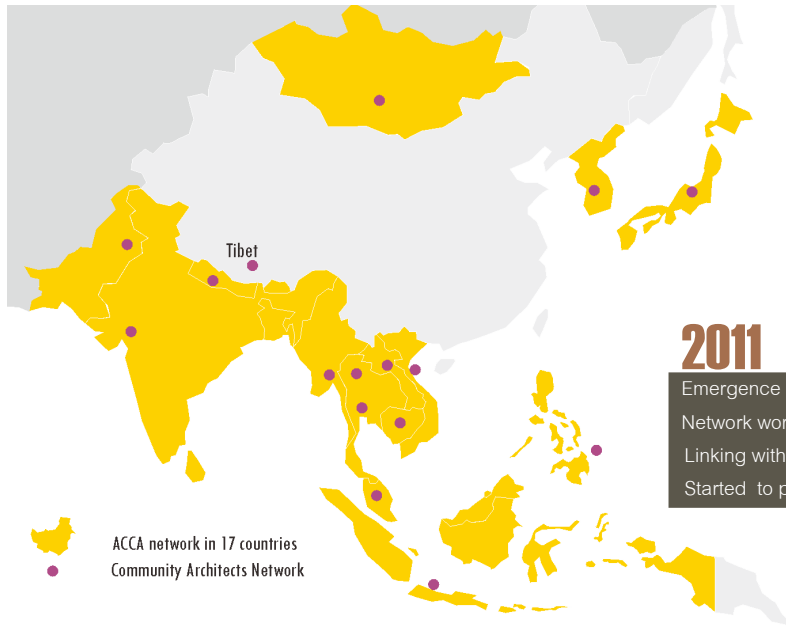

ACCA network in 17 countries  
Community Architects Network

Fiji

# What we want to see in the future

- Horizontal network as the active platform for learning & sharing
- Sub-regional group that can work together closely and intensively
- Sustainability of CAN groups (especially the new & young groups), linking with community platform at city level
- Change in architectural and planning curriculum within which issues of people housing, humanitarian design and planning are addressed
- New collaboration with new partners who believe in people's potential

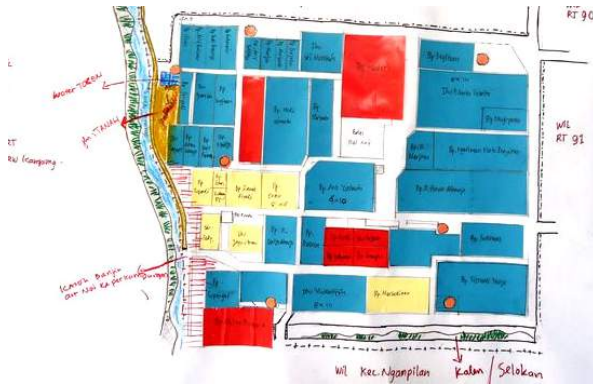

## Thailand

Group: Arsonsip Institute of the Art, Contact person: Jo Thana, email: thana.uthai@gmail.com  
Group: Community architect unit in CODI, Contact person: Ae Chaiwat, email: chaiwat\_r22@hotmail.com  
Group: Openspace, Contact person: Ploy Kasama, email: archazama@gmail.com  
Group: Kon.Jai.Baan, Contact person: Tee Supawut, email: architect\_once@hotmail.com

## Lao PDR

Group: Community architect working with WCEP, Contact person: Maykham,  
email: mk\_architect@hotmail.com

## Vietnam

Group: Vietnam YP, Contact person: Nga, email: nypvngroup@googlegroups.com

## Cambodia

Group: CAN-CAM, Contact person: Nysten and Yokly,  
email: nystenhou@gmail.com, yesokly@gmail.com

## Myanmar

Group: Volunteer group working with WFW, Contact person: Lizar email: vanlizar@gmail.com

## Malaysia

Group: Community architect in Penang, Contact person: Ng Hooi Seam, email: nghnji@gmail.com  
Group: B.K. OOI ARCHITECT, Contact person: Bok Kim, email: ooibokkim@gmail.com  
Group: A T GOH ARCHITECT, Contact person: Goh Ai Tee, email: gohaitee@gmail.com

## Philippine

Group: TAMPEI, Contact person: Vhal, email: vhal\_drew27@yahoo.com  
Group: TAO-Pilipinas, Inc., Contact person: Arlene, email: arlene.lusterio@gmail.com  
Group: PANIRAHANAN, INC., Contact person: Rolando, email: rollepalcio@gmail.com

## Indonesia

Group: ARKOM, Contact person: Yuli, email: yuli\_kusworo@yahoo.com  
Group: Volunteer Network for Humanity, Contact person: Ivana, email: leechoes@gmail.com

17 countries, 27 groups : **Our network  
Mongolia**

Group: Community architect working at UDRC, Contact person: Batdorj,  
email: bat\_ub@yahoo.com

## Japan

Group: CASE Japan, Contact person: Keke, email: keke@guitar.ocn.ne.jp

## Korea

Group: Community Architect working support community,  
Contact person: Boram, email: boram.kim.hur@gmail.com  
Group: Asian Bridge, Contact person: Minha Lee, email: asianbridge21@gmail.com

## Tibet region

Group: Tibet Heritage Funds (THF), Contact person: Pimpim, Yutaka,  
email: pemamarpo@yahoo.com.hk, pingzifeng@hotmail.com

## Pakistan

Group: Technical Training Resource Centre (TTRC), Contact person: Sirajuddin,  
email: sirajttrc@yahoo.com, thettrcorangi13@yahoo.com

## India

Group: Hunnar Shaala Foundation, Contact person: Vrunda,  
email: vrundavaghela@gmail.com

## Nepal

Group: Lumanti Support Group for Shelter, Contact person: Lumanti,  
email: lumantijoshi@gmail.com

## Srilanka

Group: SEVANATHA, Contact person: Ranjith, email: ranjith.kap@gmail.com

## Fiji

Group: CAN PACIFIC, Contact person: Hugo, email: hugo@informalism.net

Development interventions should try to create space for people to be the doers, for them to be able to lead the development process with confidence. We just need to understand the techniques to unlock this people's energy and to channel it into a creative new force for city development.

## About community architects network - CAN

CAN is a network of architects, planners, para-professionals, academia, and community builders founded in 2010. Through sharing of practical skills and making creative contributions, we facilitate community-driven processes through our skills in participatory design and planning in which people are the key actors.

**Address:** Asian Coalition for Housing Rights (ACHR)  
73 Soi, Sonthiwattana 4, Ladprao Road Soi 110,  
Bangkok 10310, Thailand [www.achr.net](http://www.achr.net)

**Contact person:**

Mr. Chawanad Luansang "Nad"  
e-mail: [chawanad@hotmail.com](mailto:chawanad@hotmail.com)

Mr. Supawut Boonmahathanakorn "Tee"  
e-mail: [archite\\_t\\_once@hotmail.com](mailto:archite_t_once@hotmail.com)

**Facebook:** <http://www.facebook.com/CommunityArchitectsNetwork>



CAN  
community architects network

